



Eagle Scout Service Project Workbook



BOY SCOUTS OF AMERICA®

Eagle Scout candidate's name Jonathan Zarger

Attachment 1

- **Project Description-:** My project is to design and build a Wood Cover and a Mini-Dig Sandbox. The Wood Cover is a simple shelter designed to keep wood dry. A Mini-Dig is a sandbox with dinosaur fossil toys at the bottom to emulate an archeological dig. Both the dig and the cover will be mostly assembled off site, and then will be transported to Dinosaur Hill. My crew will then dig holes, pour cement, and then fully assemble both. To get the materials necessary to construct my project, I will need to do a significant amount of fundraising through a combination of can drives and hopefully donations. The composite material for the Mini-Dig has already been donated by my dad. After I have my materials, I will schedule weekend work days. Hopefully, four or five should be sufficient with 2 shifts. I will create templates out of plywood to ensure that angled pieces are cut and holes are drilled accurately. After the pieces have been assembled, I use my dad's truck to move them to Dinosaur Hill. My crew will then dig the holes and place the posts in them with cement. The dig and cover will then be assembled on top of their respective posts.
- **How it will benefit Dinosaur Hill:** My project will help Dinosaur Hill with their many programs. Dinosaur Hill frequently uses their fire bowl for family programs, but they do not have a good way to store wood. Currently, it is stored under a small blue tarp. The wood gets wet easily and it is not very accessible. With a wood shelter, they will be able to easily store about a cord and a half of wood and have an ample supply of dry wood when they need it. The Mini-Dig will allow Dinosaur Hill to teach children about paleontology. It will also be a fun activity for children during classes at the Nature Preserve. Their current dig is about 15'x15' and is too large to be used easily or to have open 24/7. It is currently only used for special programs. The smaller 4x6 dig that I am building will be much easier to use.
- **Safety Issues**

The main safety concerns consist of the use of power tools. Preferably, younger scouts will not be allowed to use them, but if necessary, they will only do so under scrupulous supervision. Other less prominent safety concerns could occur from the use of hand tools. They will still be used under supervision to attempt to prevent accidents. In case of small injuries, I will keep a First Aid kit on hand. I will also be supplying safety glasses and gloves when necessary. I will also have at least two adults available for supervision.

Before



This is the wood pile at Dinosaur Hill. It is just wood stacked under a tarp. It isn't in very good condition, and not much can be stored. The picture on the right shows the site where Dinosaur Hill wanted like the shelter.



The picture on the left shows the large Dinosaur Dig. It has a tarp over it and can't be used by anyone passing by. The picture on the right shows the site where Dinosaur Hill wanted the mini-dig.

Splitting Wood



Construction



Construction



Site Prep



Assembly and Installation



Assembly and Installation



Shingles and Dino Bones



Shingles and Dino Bones



Shingles and Dino Bones



Portable and Wrap-up



Timeline and Job List

Woodshed Construction Plan		Hours
1	Complete Trusses: Drilling, assembly, nailing gussets	4
1-b	2 Trusses: Cut out filler and plywood	1
2	6 - 4x4 Posts: Cut to length and 45°, drill holes	3
3	6 - 4x4 stub posts x 24". Cut to length and 45°, drill holes	2
4	2x4 x 10': Cut to length, drill holes	2
5	Attach 4x4 stub to trusses	1
6	Lay Trusses and stub on side, connect 2x4 - 10'	1
7	Nail 2x4 - 10' one side to trusses	1
8	Add remaining trusses	1
9	Measure and cut plywood	1
10	Disassemble	1
11	Paint	2

Dino Dig Construction		
1	Cut Composite boards	0
2	Drill Composite Boards	1
3	Cut/Drill 4x4s	1
4	Cut/Drill 2x6s	1
5	(Mark and nail joist holders) Step Removed	1
6	Assemble 2x6s and 4x4s	1
7	Nail 2x4s to joists	1
8	Place/Nail Composite boards	1
9	Screw on landscaping fabric	1
9a	Install 4 Corner Pieces	1
10	Assemble Composite Board	1

Installation		
Day 1		
1	Locate Placement, set stakes, drill holes	3
Day 2		
2	Move materials to site	2
	Assemble shed	1
	Set shed + dig in holes	1
	Level + square	1
3	Mix+pour cement, Backfill holes	3
Day 3		
4	Nail plywood	1
	Nail Drip Moulding	1
	Nail shingles	1
5	Fill with wood	1.5
	Fill with sand	1.5

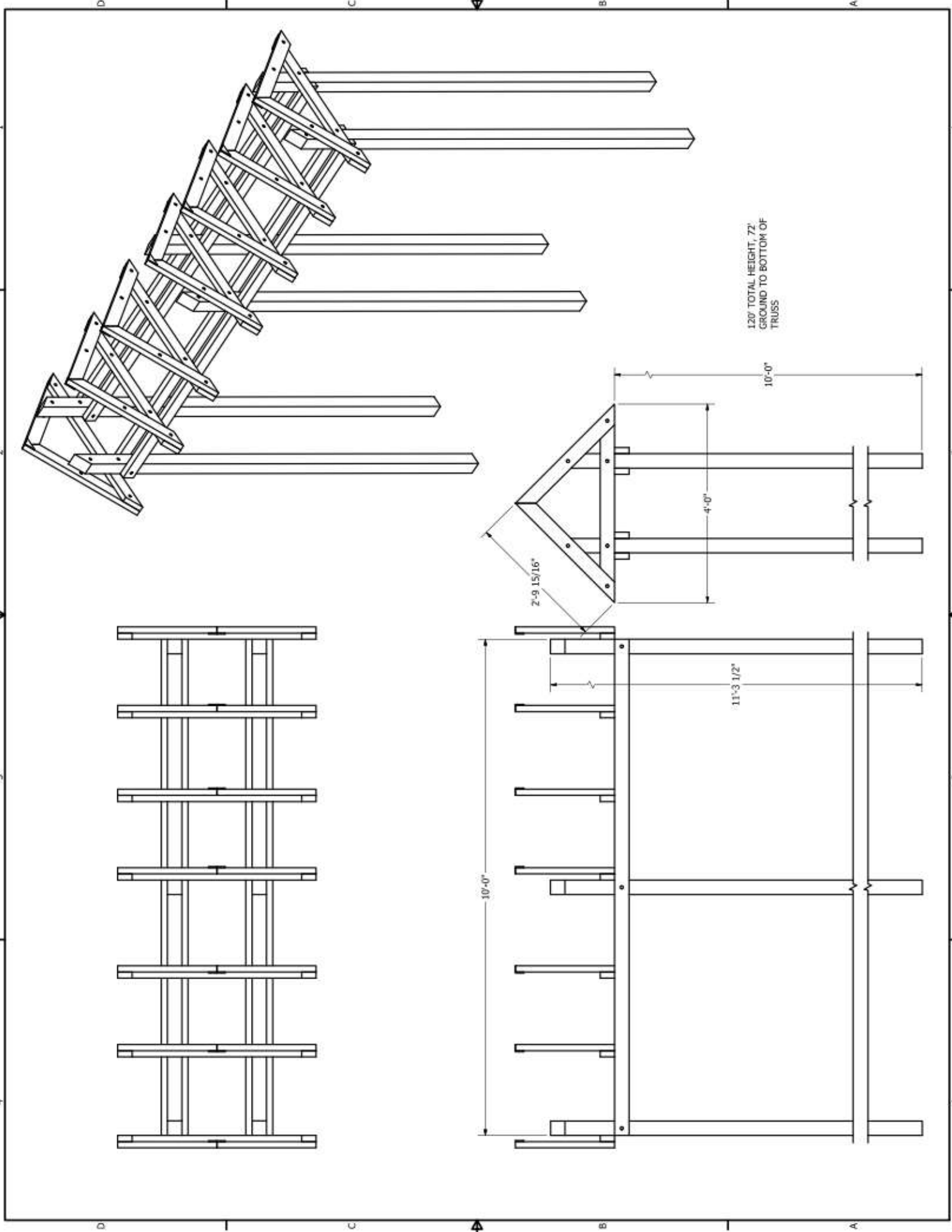

120' TOTAL HEIGHT, 72' GROUND TO BOTTOM OF TRUSS

$2'-9 \frac{15}{16}"$

10'-0"

4'-0"

11'-3 $\frac{1}{2}"$

10'-0"

D

C

B

A

D

C

B

A

2

2

3

3

4

4

1

1

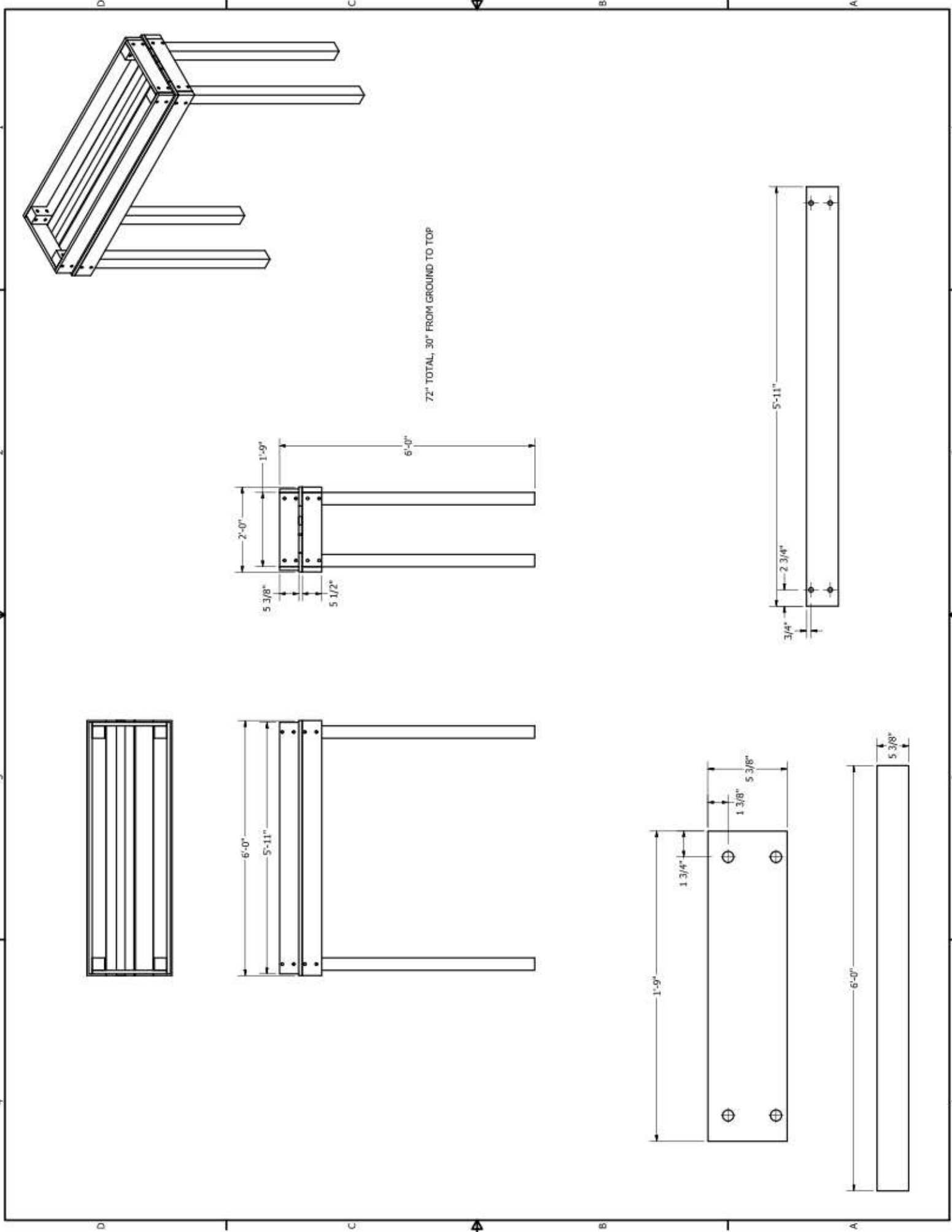

Eagle Scout Service Project Report

*To be completed after the service project has been concluded. It is not necessary to provide lengthy answers.
Please be prepared to discuss your responses at your board of review.*

Eagle Scout candidate: Jonathan Zarger

Once planning was completed, when did the work begin? 7/12/12 When was it finished? 9/28/12

Summary

What went well?

The construction and installation both went very successfully, as did the fundraising. Due to thorough planning, there were no unexpected situations. Everything went as planned.

What was challenging?

The planning of all the details was the most challenging for me, and so was making sure that everyone had a job to do during the installation. It was also challenging to ensure that everyone was doing their job properly so that everything could come together successfully.

Changes

What changes were made as the project was conducted?

There were changes made to the installation procedure, such as deciding to mostly assemble the cover before the installation day. There was a change in the dimension in the size of the mini-dig that Dinosaur Hill supported.

Leadership

In what ways did you demonstrate leadership?

I demonstrated leadership in multiple ways. First, I demonstrated it through the planning stages of my project by making sure I had a clear and well defined plan. Before I began work, I knew my plan and what would be involved in my project. Second, I demonstrated while the project was in progress. I led and supervised scouts as they helped install my project at Dinosaur Hill.

What was most difficult about being the leader?

What was most difficult about being a leader for me was stepping up and taking charge to make sure everything went smoothly.

What was most rewarding about being the leader?

The most rewarding part about being the leader was seeing everything come together successfully around me at the end of the project.

What did you learn about leadership, or how were your leadership skills further developed?

I learned more about how to handle being in charge of group of people and getting them to do things the way that need to be done. By necessity I learned much about how to plan things out to be prepared for all possibilities. I learned how to listen to feedback and how to improve designs while preparing models and presenting them to Dinosaur Hill.

Materials, Supplies, Tools

Were there significant shortages or overages of materials, supplies, and tools? If so, what effect did this have?

There were no shortages in materials, supplies, or tools. There were minor overages in shingles and paint, but I gave the leftover materials to Dinosaur Hill.

Eagle Scout Service Project Report, continued

Entering Service Project Data

The Boy Scouts of America collects information on the hours worked* on Eagle Scout service projects because it points to achievement on our citizenship aim. So that you can assist with the data collection, please keep a list of the people who help on your project, and a log of the number of hours they work. Then, please provide the information requested below. Be sure to include yourself, and the time spent on planning.

	No.	Hours
The Eagle Scout candidate	1	See
Registered BSA youth members		more
Other youth (<i>brothers, sisters, friends, etc., who are not BSA members</i>)		defined
Registered BSA adult Scout leaders		sheet
Other adults (<i>parents, grandparents, etc., who are not BSA members</i>)		
Totals	0	0

*There is no requirement for a minimum number of hours that must be worked on an Eagle Scout service project.

If you have been told you must meet a minimum number of hours then you may lodge a complaint with your district or council. If you have given leadership to an **otherwise worthy** project and are turned down by your board of review solely because of a lack of hours, you should appeal the decision.

Funding

Describe your fundraising efforts:

To raise the necessary funds, I did several things. First, I did a bottle and can drive to raise some funds to start the project. Then I went to local lumber and hardware stores to ask if they would be able to donate materials. The remaining funds came out of my scout account.

How much was collected? \$260

How much was spent? \$443.22

If your expenses exceeded funds available, explain why this happened, and how excess expenses were paid.

Expenses did exceed funds available, but they were covered by donations from local lumber stores and from my scout account.

If you had money left over after the project completion, did you turn it over to the project beneficiary? If "No," when and how long will that take place?

There was no left over money from my project.

How were the donors thanked?

The donors from Home Depot and Lowe's will be thanked with letters. Thank you notes will also be sent to those who helped with my project.

Photos and Other Documentation

If you have them, attach any "before," "during," and "after" photographs. Attach letters, maps, handouts, printed materials, or similar items that might be helpful to your board of review.

Candidate's Promise

On my honor as a Scout, I was the leader of my Eagle Scout service project and completed it as reported here.

Signed:

Date:

Completion Approvals

In my opinion, this Eagle Scout service project meets Eagle Scout requirement 5, as stated on page 4 of this workbook.

Beneficiary name:

Unit leader name:

Signed:

Date:

Signed:

Date:

Bill of Materials

Wood Cover:

Item

Lumber:

4 x 4 x 12 PT
2 x 4 x 10 PT
4 x 8 x 15/32" Plywood
2x4x10' White Pine (Temp Part)

Fasteners

10d Nails (1 lb boxes, 50/box)
3/8 x 7in Carriage Bolt
3/8 Washers
32 -3/8 Nuts
3/8 x 4 Carriage Bolts

Other

Shingles (60 square feet packs)
Drip Molding - 40'

Minidig(s):

Item

Lumber:

2 x 6 x 10 PT
2 x 6 x 8 PT
2 x 4 x 8 PT
4 x 4 x 8 PT
4 x 4 x 12 PT
1 x 6 x 12 Composite Deck Plank
1 x 6 x 10 Composite Deck Plank
4 x 8 x 15/32" Plywood

Fasteners

2 x 4 Joist Hanger
3/8 x 6" Carriage Bolt
1/4 x 3" Hex Screw
1/4 x 2" Hex Screw

Other

Fossils/Bones
Sand Filler Bags

Estimates

# Est	Cost each	Item total
6	9.86	59.16
11	3.97	43.67
3	14.57	43.71
0	0	0
		Sub Total
		146.54
2	3.98	7.96
18	2.16	38.88
0	0	0
0	0	0
0	0	0
		Sub Total
		46.84
2	31.5	63
0	0	0
		Sub Total
		63
		Cover total
		256.38
#	Cost each	Item total
2	5.97	11.94
0	0	0
2	1.97	3.94
2	6.57	13.14
0	0	0
4	37.73	150.92
2	31.44	62.88
1	14.57	14.57
		Sub total
		257.39
8	1.75	14
8	1.8	14.4
16	0.27	4.32
0	0	0
		Sub total
		32.72
		30
12	6.76	81.12

Final Cost

#	Cost	Item Total	Discount
6	14.97	80.82	LW
11	4.97	-0.3	HD
3	11.99	32.37	LW
1	4.05	3.64	LW
		116.53	
		0	
2	3.98	0	TZ
18	1.42	23.04	LW
32	0.01	0	TZ
32	0.01	0	TZ
14	0.61	0	HD
		23.04	
3	27.66	82.98	
4	3.56	14.24	
		97.22	
		236.79	
#	Cost	Item Total	Discount
0	0	0	
2	4.97	0	HD
1	3.77	0	GD
0	0	0	
2	6.57	13.14	
4	37.73	0	TZ
3	31.44	0	TZ
0	0	0	
		13.14	
0	0	0	
16	1	14.4	LW
0	0	0	
16	0.27	0	TZ
		14.4	
1	50.47	50.47	
5	3.18	6.36	TZ

2 1/2 x 4 x 1/2 ' Plastic Tub
 Plastic Tub Filler
 Landscaping fabric
 Plastic Shovels

1	6	6
5	15.98	79.9
24	0.12	2.88
0	0	0
		Sub Total
		199.9
		Dig Total
		490.01
#	Cost each	Item total
15	3.75	56.25
1	20	20
		Misc Total
		76.25
		Retail Cost
		822.64

1	14.97	14.97	
1	18.99	18.99	
24	0.12	0	TZ
1	10.33	10.33	
		101.12	
		128.66	
#	Cost	Item Total	
15	3.46	51.9	
1	25.87	25.87	
		77.77	
		Discounted Cost	
		443.22	

Misc items
 Ready-Mix Cement (80 Pound Bags)
 Laytex Paint (Gallon)

Home Depot Website used
 for pricing estimates

Total Material Cost - Retail Pricing: \$822.64
 Cost of Food and Drinks on Work Days \$85.22
 Value of Discounts and Donations: -\$364.93
Total Out Of Pocket Cost: \$542.93

Total Value of Fundraising: \$258.00
 Amount Used from Scout Account \$284.93



D C B A

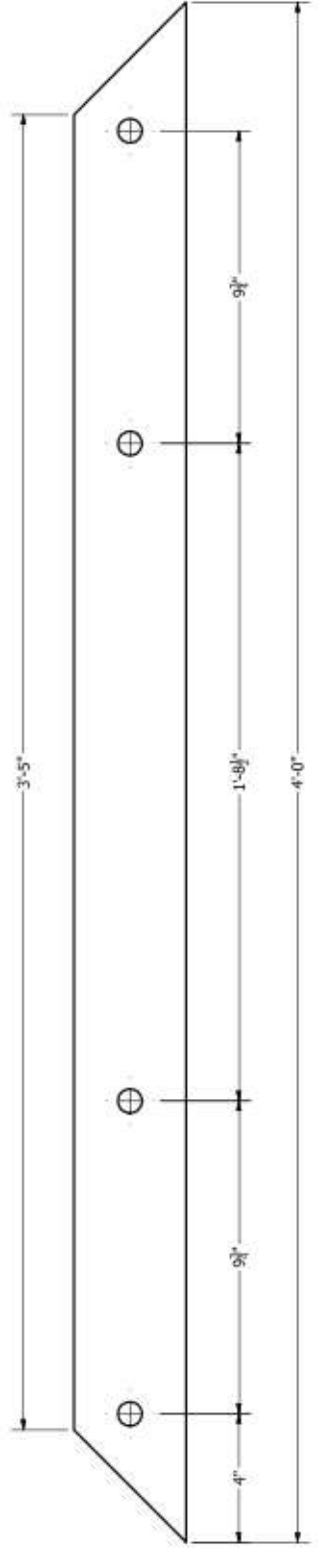
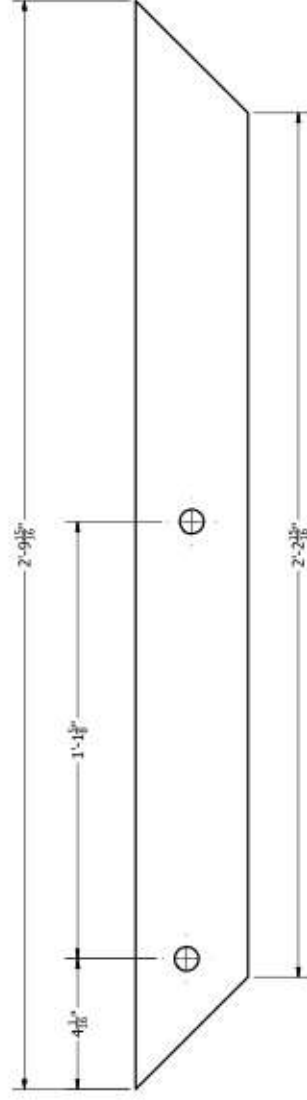
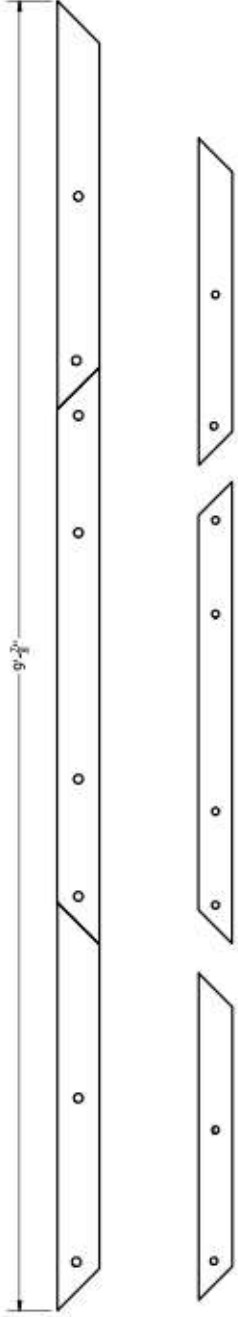
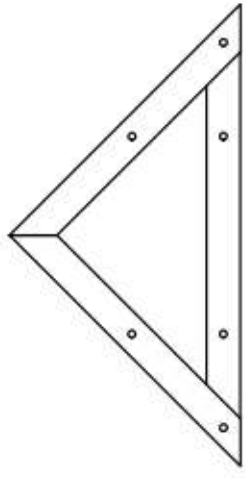

D C B A

A B C D

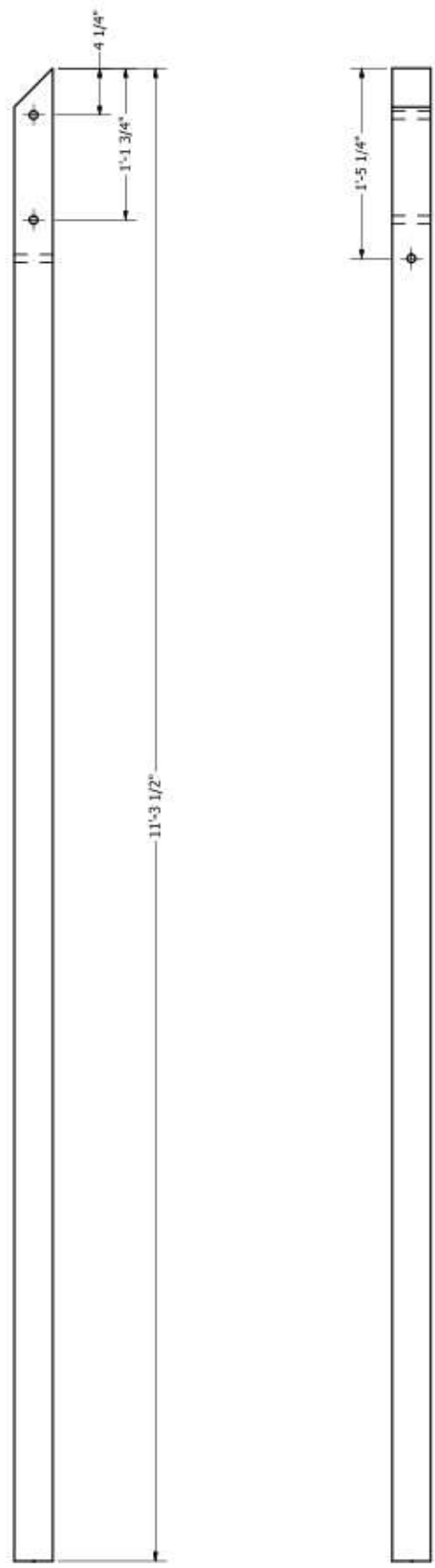
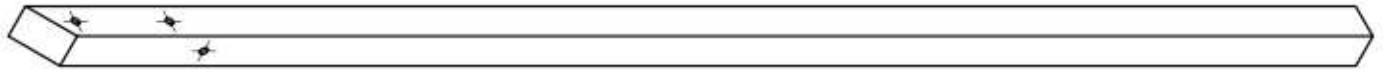

A B C D

